

# OFFSHORE OLYMPIA

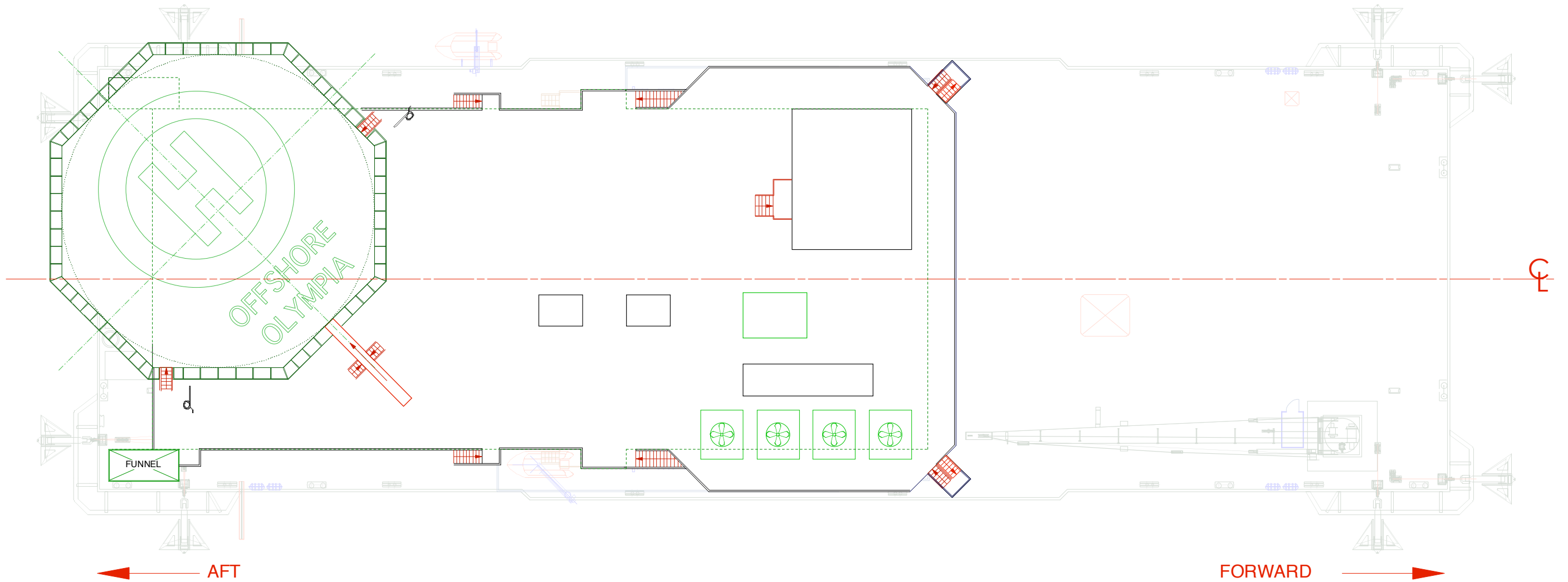

## LEVEL SIX

<p><b>PRINCIPLE DIMENSIONS</b></p> <p>Length 96.35m          Breadth 30.25m          Depth 6.00m          Operating Draft 2.90m</p>	<p><small>CLIENT</small></p> <p><b>INTERSHIP LIMITED</b>          KINGSTOWN          ST. VINCENT &amp; GRENADINES          Tel: - 917-294-6623 Fax: - 212-253-4216          E-mail: - charter@barges.com</p>	<p><small>TITLE</small></p> <p><b>"OFFSHORE OLYMPIA"          WORK / CRANE BARGE          GENERAL          ARRANGEMENT          - LEVEL SIX</b></p>
	<p><small>ARCHITECTS</small></p> <p><b>MN PARTNERSHIP</b>          ARCHITECTS &amp; SPACE PLANNERS  <small>Crawley, England, East. Coast. P.O. Box 204, Scotland          Tel: 01763 853128 Fax: 01763 853128          E-mail: mnpartner@bt.co.uk</small></p>	<p><small>DATE</small></p> <p>APRIL 2005</p> <p><small>SCALE</small></p> <p>1:300 @ A3</p> <p><small>DWG NO.</small></p> <p><small>REV.</small></p>

THIS DRAWING IS THE PROPERTY OF ENGINEERING DESIGN SERVICES AND MUST NOT BE TRANSMITTED TO A THIRD PARTY WITHOUT PRIOR WRITTEN APPROVAL FROM THE PROPRIETOR OF ENGINEERING DESIGN SERVICES.